

NOTES:

1. MINIMUM 4000 PSI, CONCRETE @ 28 DAYS.
2. STRUCTURED DESIGNED FOR PEDESTRIAN LIVE LOAD, 2 FT. OF COVER AND ASSUMING WATER TABLE DEPTH 1.5 FT.
3. REINFORCEMENT, GRADE 60 ASTM A615:
 - SLAB & TOP: #5 BAR @ 6" O.C. SHORT DIRECTION,
#5 BAR @ 12" O.C. LONG DIRECTION
 - BASE WALLS: #5 @ 12" O.C.E.W.
 - RISER WALLS: DOUBLE MAT: #5 BAR @ 6" O.C. HORIZONTAL,
#5 BAR @ 12" O.C. VERTICAL

APPROXIMATED WEIGHT:
 3' BASE: 17.22 TON
 4'-6" RISER: 12.30 TON
 6" WEIR WALL: 6.65 TON
 TOP: 9.02 TON



DWG. NO.	18X8 GT.DWG	TITLE	FPC SUBMITTAL DRAWING FOR - 6000 GT
SCALE	NTS	DATE	DRAWN BY GET

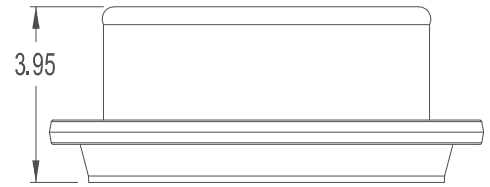
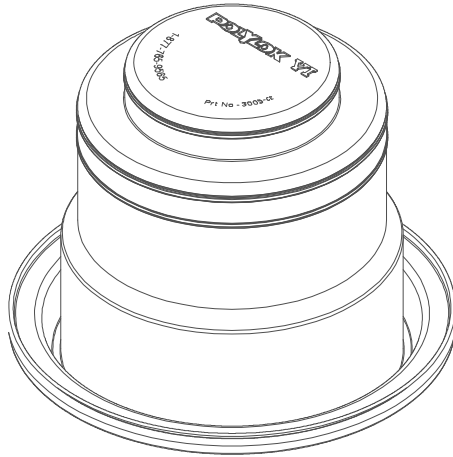
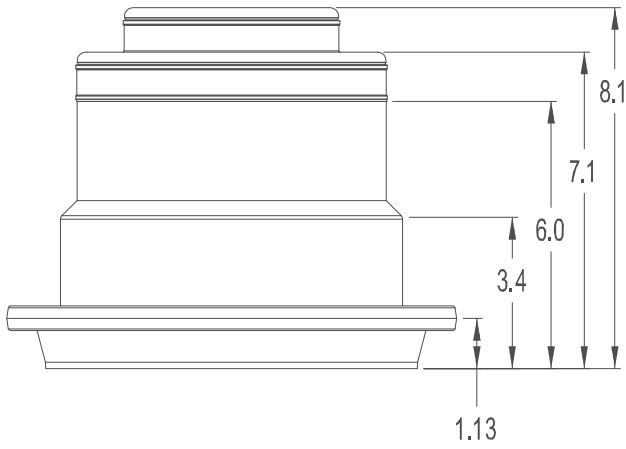
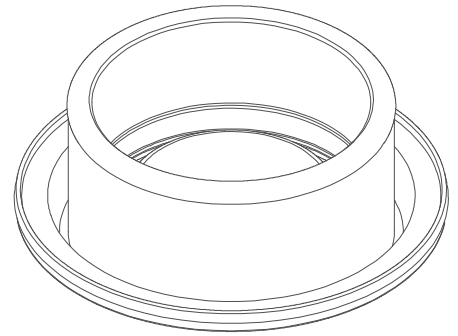
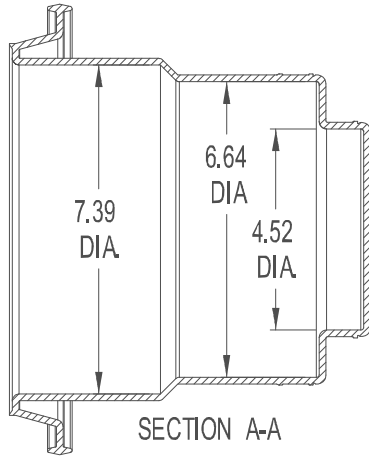
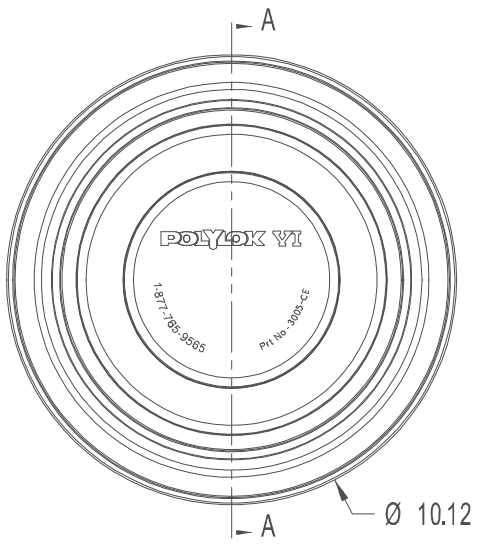

COLLAPSED BOOT

POLYLOK TYPE VI 4" - 6" BOOT SEAL
PART NO. 3005-CE
MATERIAL - RUBBER