

PLAN

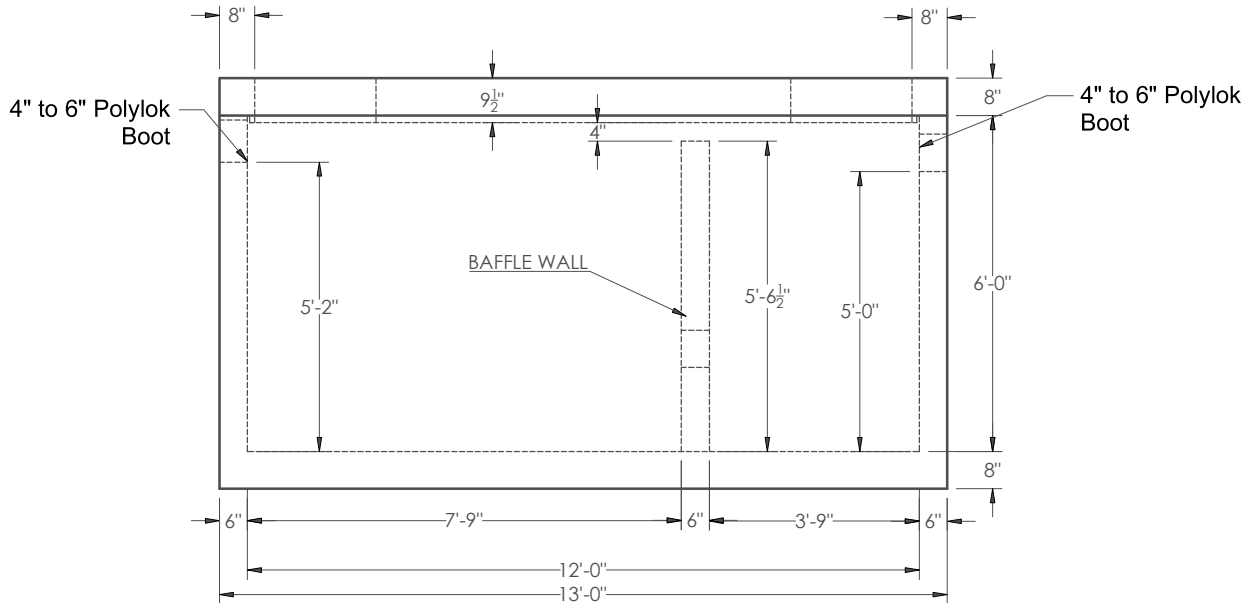

ELEVATION

NOTES:

1. CONCRETE STRENGTH = 5000 PSI @ 28 DAYS MINIMUM
2. MANUFACTURED PER ASTM C1613
3. STRUCTURE DESIGN FOR HS-20 LOADING W/ 0 TO 2 FT. COVER AND ASSUMED WATER TABLE DEPTH 3 FT.
4. REINFORCEMENT:
 - TOP: # 6 BAR @ 6" O.C. SHORT DIRECTION, # 6 BAR @ 12" O.C. LONG DIRECTION
 - WALLS: #6 BAR @ 8" O.C. HORIZONTAL
#5 BAR @ 6" O.C. VERTICAL
 - SLAB: # 5 BAR @ 6" O.C.E,W, (USE 3" CHAIR)
 - BAFFLE WALL: #5 BAR @ 12" O.C.E.W.
5. 26" HOLES IN TOP FOR EJ 1337 R/ C (GREASE TRAP)(CAST-IN DESIGN AVAILABLE)
6. BASE WEIGHT = 13.80 TON
7. TOP WEIGHT = 6.00 TON
8. BAFFLE WALL WEIGHT = 1.65 TON

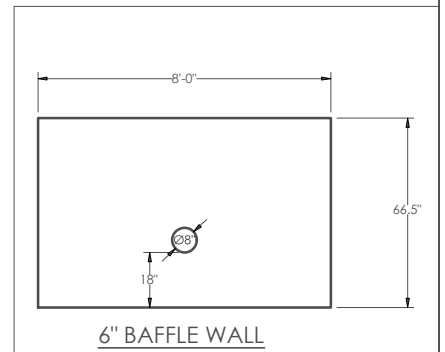

DWG. NO.	
SCALE	NTS

TITLE	FPC SUBMITTAL DRAWING FOR 3500 GAL G.T.	
DATE	05-22-2017	DRAWN BY GET

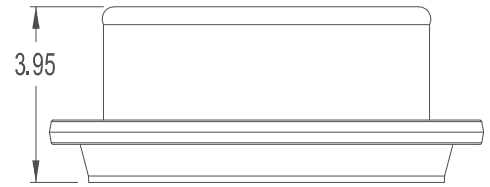
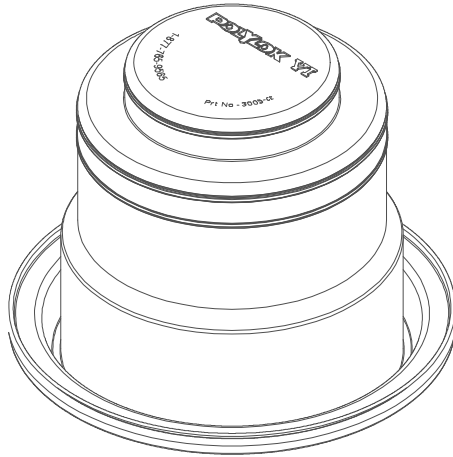
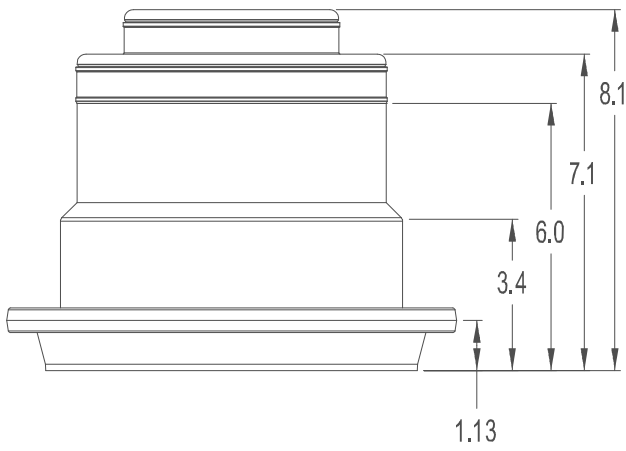
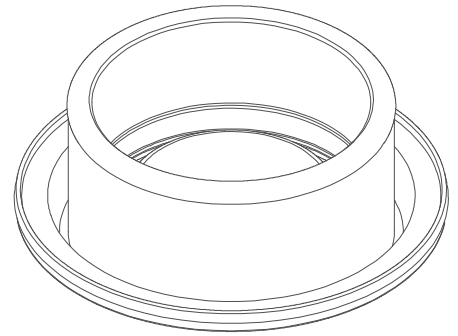
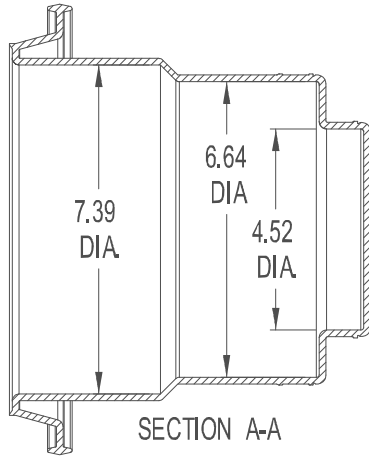
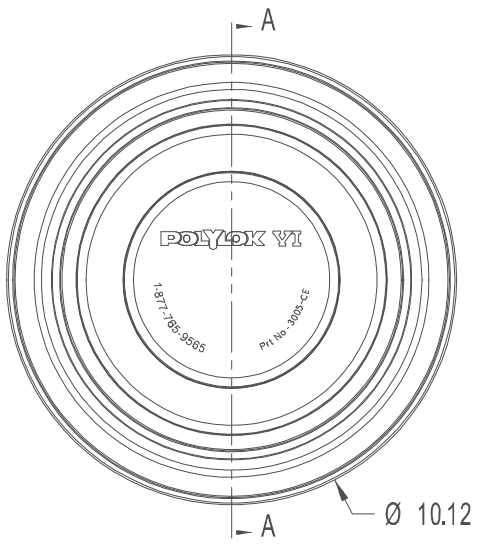

COLLAPSED BOOT

POLYLOK TYPE VI 4" - 6" BOOT SEAL
PART NO. 3005-CE
MATERIAL - RUBBER