

NOTES:

1. CONCRETE STRENGTH = 5000 PSI @ 28 DAYS MINIMUM
2. MANUFACTURED PER ASTM C1613
3. STRUCTURE DESIGN FOR HS-20 LOADING W/ 0 TO 2 FT. COVER AND ASSUMED WATER TABLE DEPTH 3 FT.
4. REINFORCEMENT:
  - 8" TOP: # 6 BAR @ 6" O.C (SHORT DIRECT.), # 6 BAR @ 12" O.C.(LONG DIRECT.)
  - WALLS: #6 BAR @ 8" O.C. HORIZONTAL
  - #5 BAR @ 6" O.C. VERTICAL
  - SLAB: # 5 BAR @ 6" O.C.E.W. (USE 3" CHAIR)
  - BAFFLE WALL: #5 BAR @ 12" O.C.E.W.
5. 26" HOLES IN TOP FOR EJ 1337 R/ C (GREASE TRAP)(CAST-IN DESIGN AVAILABLE)
6. BASE WEIGHT = 14.5 TON
7. TOP WEIGHT = 6.0 TON
8. BAFFLE WALL WEIGHT = MAX. 1.6 TON

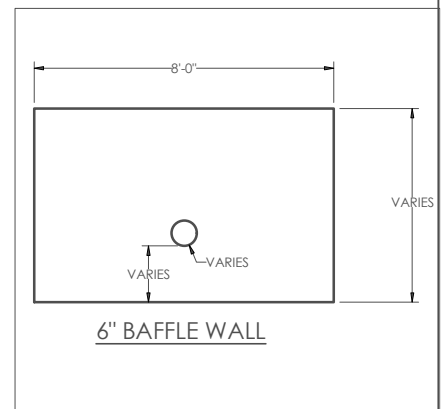

	DWG. NO.	TITLE	
	SCALE	DATE	DRAWN BY
	NTS	05-22-2017	GET
		FPC SUBMITTAL DRAWING FOR 3000 GAL G.T.	

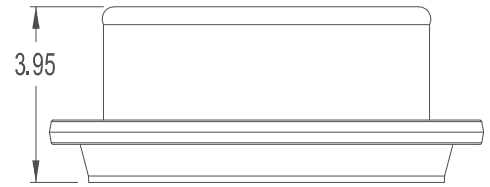
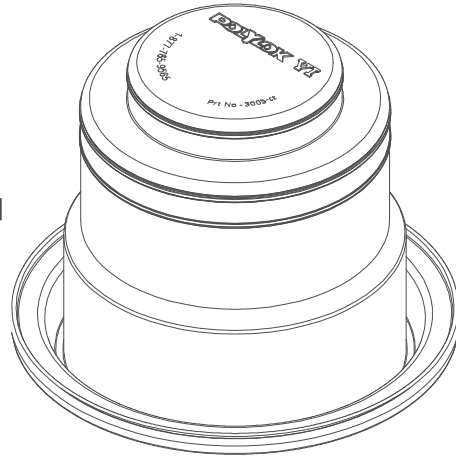
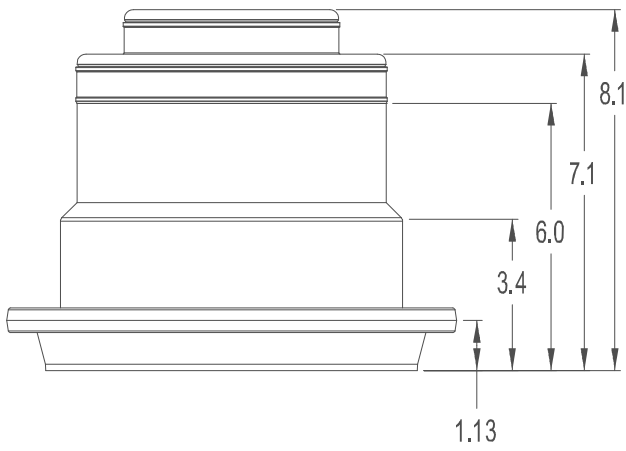
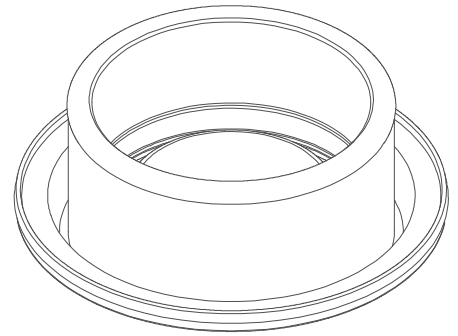
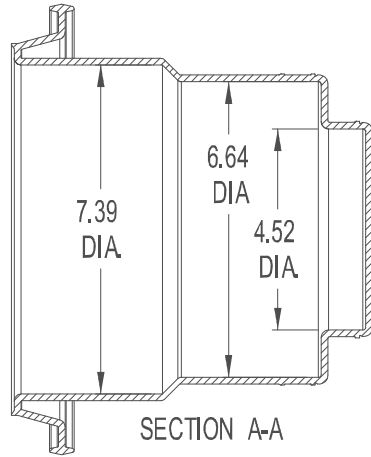
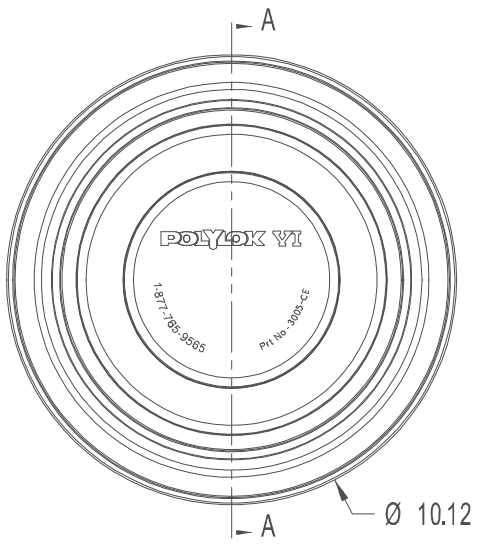

COLLAPSED BOOT

POLYLOK TYPE VI 4" - 6" BOOT SEAL  
PART NO. 3005-CE  
MATERIAL - RUBBER