

NOTES:

1. CONCRETE STRENGTH = 5000 PSI @ 28 DAYS MINIMUM
2. MANUFACTURED PER ASTM C1613
3. STRUCTURE DESIGN FOR HS-20 LOADING W/ 0 TO 2 FT. COVER AND ASSUMED WATER TABLE DEPTH 3 FT.
4. REINFORCEMENT:
  - TOP: #6 BAR @ 6" O.C. SHORT DIRECTION  
#5 BAR @ 10" O.C. LONG DIRECTION
  - WALLS: #5 BAR @ 8" O.C. HORIZONTAL, #5 BAR @ 6" O.C. VERTICAL
  - SLAB: #5 BAR @ 6" O.C. SHORT DIRECTION  
#5 BAR @ 12" O.C. LONG DIRECTION
5. 26" HOLES IN TOP FOR EJ 1337 R/ C (GREASE TRAP)(CAST-IN DESIGN AVAILABLE)
6. BASE WEIGHT = 12.0 TONS
7. TOP WEIGHT = 4.5 TONS
8. BAFFLE WALL WEIGHT = MAX. 1.2 TONS

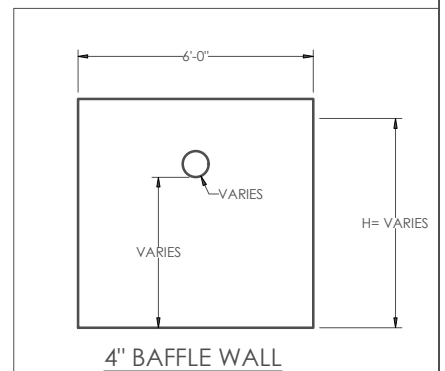

DWG. NO.	
SCALE	NTS

TITLE	FPC SUBMITTAL DRAWING FOR 2500 GAL G.T.	
DATE	05-22-2017	DRAWN BY GET

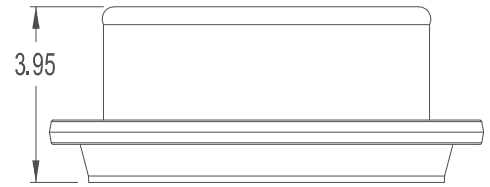
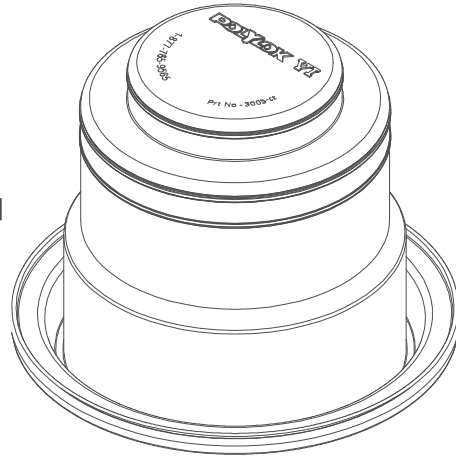
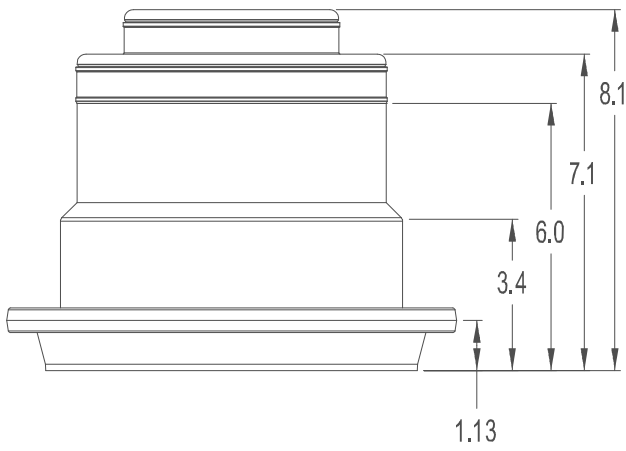
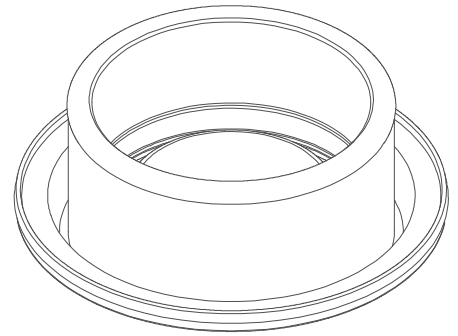
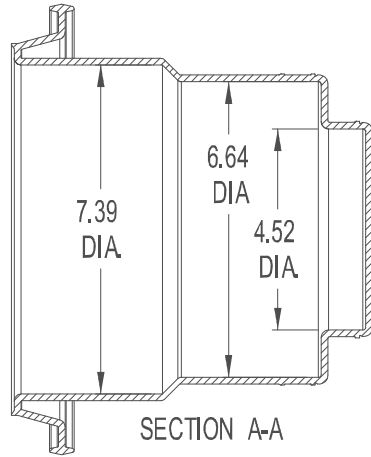
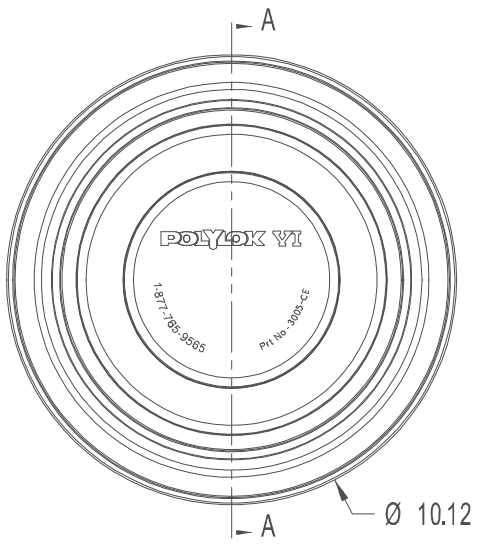

COLLAPSED BOOT

POLYLOK TYPE VI 4" - 6" BOOT SEAL  
PART NO. 3005-CE  
MATERIAL - RUBBER