

PLAN

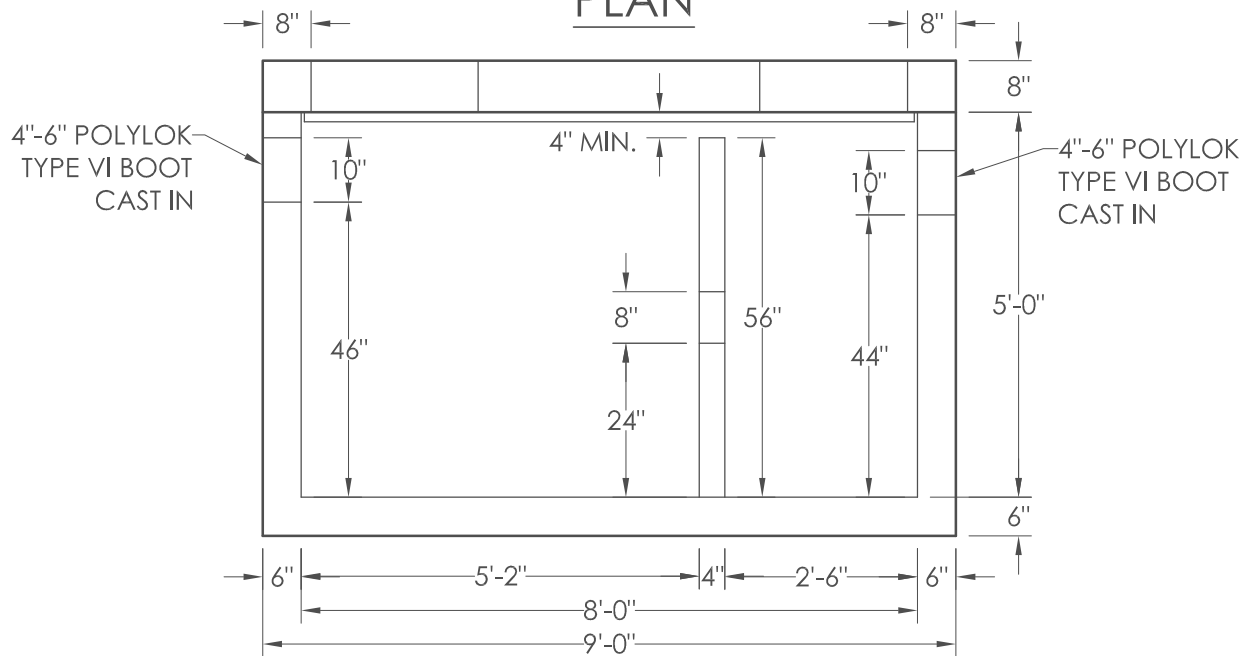

ELEVATION

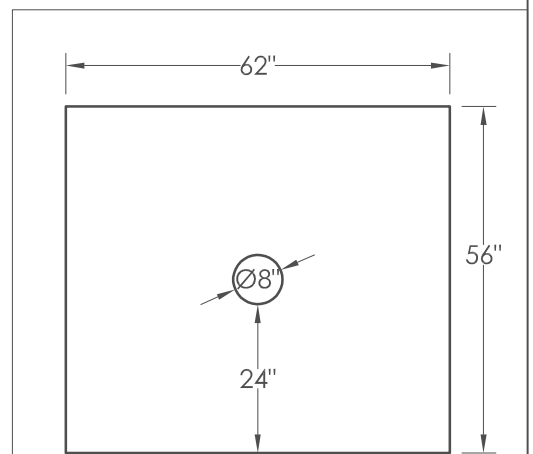

4" BAFFLE WALL

NOTES:

1. CONCRETE STRENGTH = 5000 PSI @ 28 DAYS MINIMUM
2. MANUFACTURED PER ASTM C1613
3. STRUCTURE DESIGN FOR HS-20 LOADING W/ 0 TO 2 FT. COVER AND ASSUMED WATER TABLE DEPTH 3 FT.
4. REINFORCEMENT:
 TOPS: #5 BAR @ 6" O.C. SHORT DIRECTION
 #5 BAR @ 12" O.C. LONG DIRECTION
 WALLS: #5 BAR @ 12" O.C.E.W.
 SLAB: # 5 BAR @ 12" O.C.E.W.
5. 26" HOLES IN TOP FOR EJ 1326-3RING & 1338A COVER (GREASE TRAP)(CAST-IN DESIGN AVAILABLE)
6. BASE WEIGHT = 7.23 TON
7. TOP WEIGHT = 2.63 TON
8. BAFFLE WALL WEIGHT = MAX. 0.61 TON.
9. EMI UT LIFT ANCHOR SYSTEM: 0.67" Ø, (4 pcs. in Ext. wall), 5 Ton capacity each.

	DWG. NO.	GT TANKS.DWG	TITLE	FPC SUBMITTAL DRAWING FOR 1000 GAL G.T. 5' x 8'	
	SCALE	NTS	DATE	9/24/2021	DRAWN BY JJC

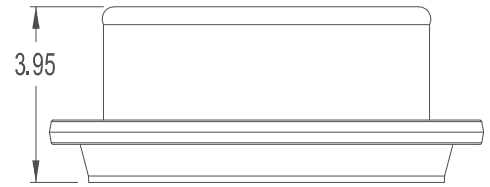
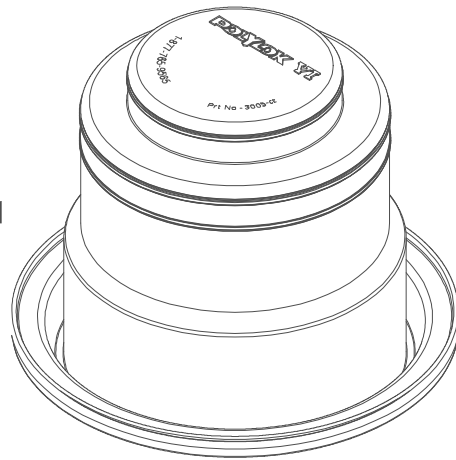
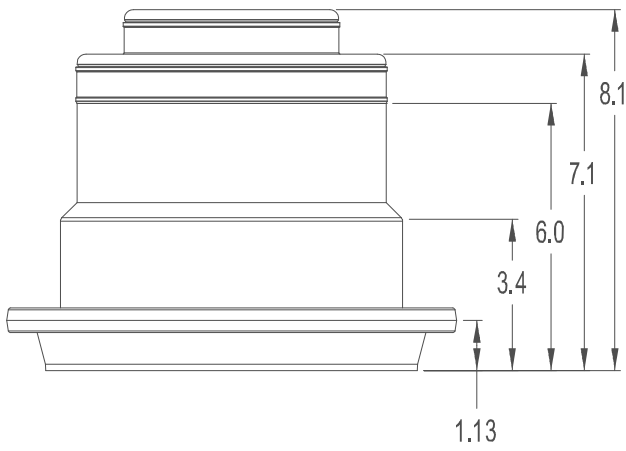
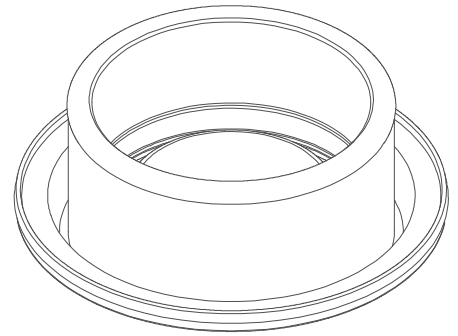
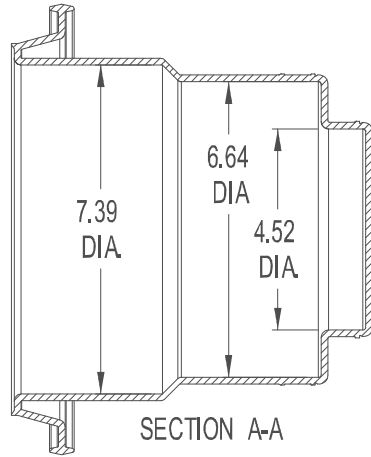
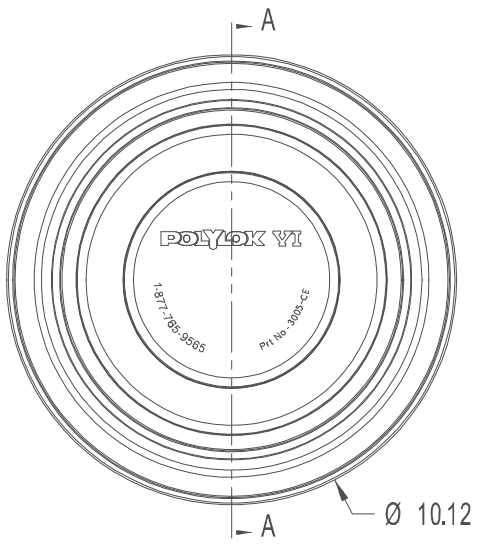

COLLAPSED BOOT

POLYLOK TYPE VI 4" - 6" BOOT SEAL
PART NO. 3005-CE
MATERIAL - RUBBER