

TOP VIEW
(FRAME & GRATE NOT SHOWN FOR CLARITY)

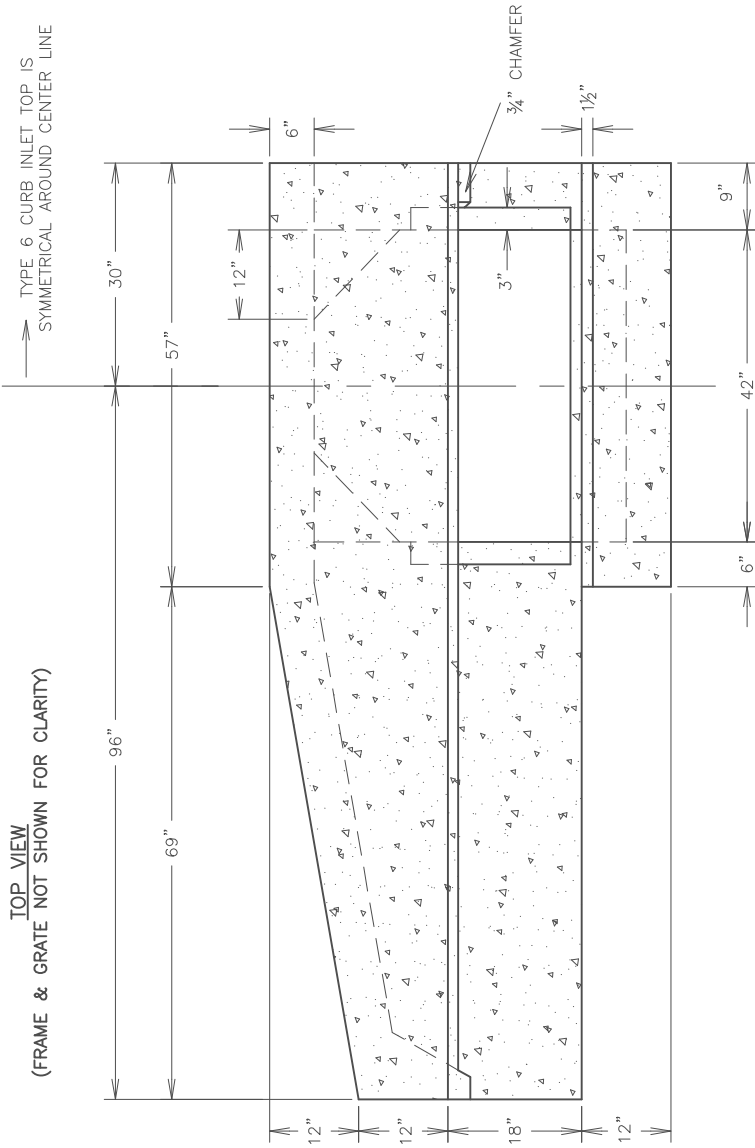

NOTES:

1. REINFORCEMENT IS NOT SHOWN FOR CLARITY. REFER TO FDOT INDEX #211 FOR MORE INFORMATION AND DIMENSIONAL REQUIREMENTS FOR CURB INLET TOPS, AS WELL AS SHEET 4 OF 5 FOR THE REINFORCEMENT TABLE.
2. SEE FDOT INDEX 200 FOR INFORMATION AND DIMENSIONAL REQUIREMENTS OF TYPE P AND J BOTTOMS.
3. FRAME AND GRATE REQUIRED: USF 5160-6310
4. LIFTING CABLE LOOPS TO BE POSITIONED ON SIDES OF CURB INLET TOP
5. APPROXIMATE WEIGHT OF TYPE 5 CURB INLET TOP: 4,000± lbs (1.00± cy)
6. APPROXIMATE WEIGHT OF TYPE 6 CURB INLET TOP: 6,000± lbs (1.50± cy)

CENTER SECTION VIEW
(PARTIAL FRAME & GRATE SHOWN)

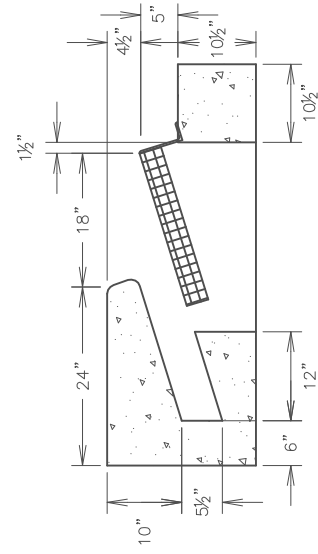

FRONT VIEW
(FRAME & GRATE NOT SHOWN FOR CLARITY)

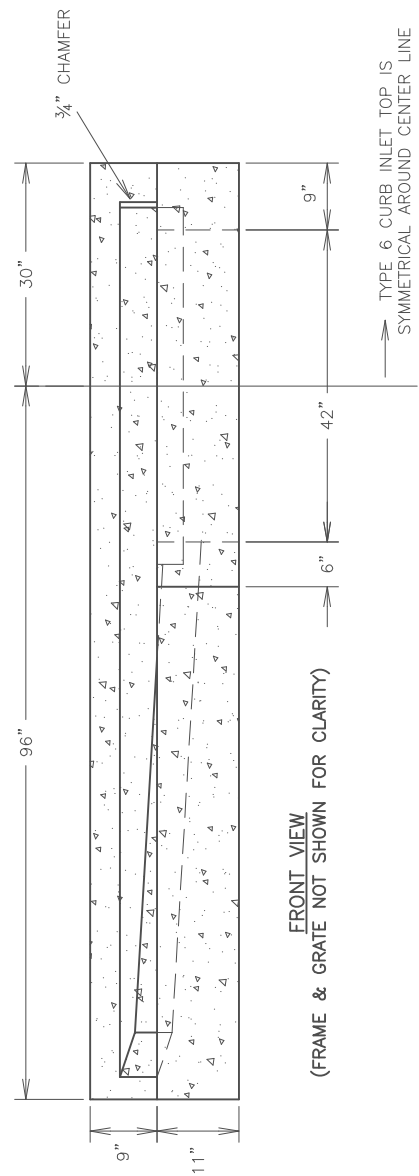

NOT TO SCALE
DIMENSIONS SUBJECT TO SLIGHT
VARIATIONS DURING PRODUCTION

PRODUCT

FDOT TYPE 5 & 6 CURB INLET TOP



DATE

12/13/11

SECTION.PAGE

01 OF 01