

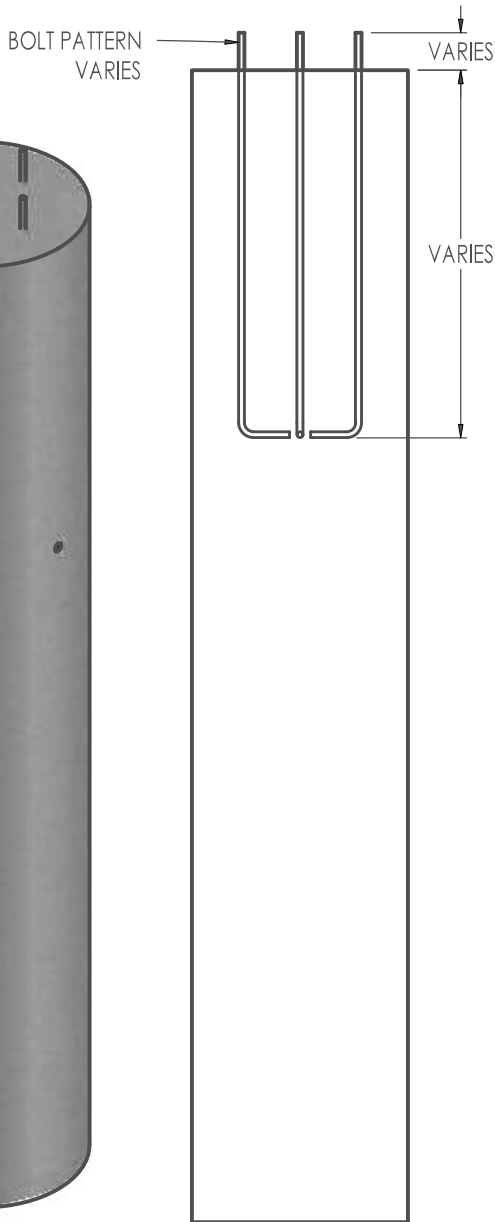

ISO VIEW

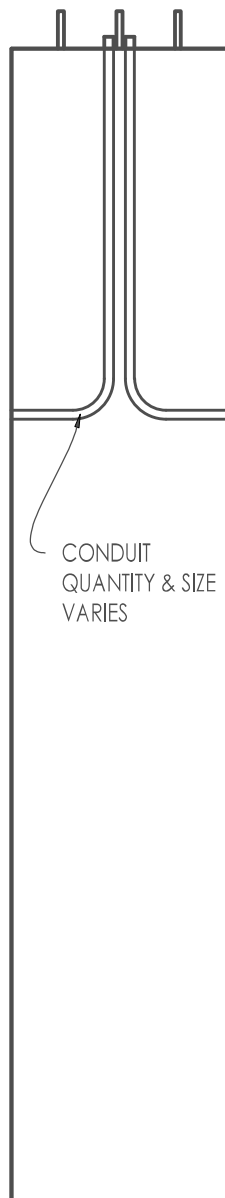

ANCHOR BOLT  
DETAIL



CONDUIT DETAIL

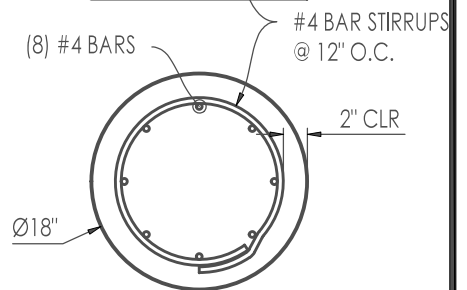
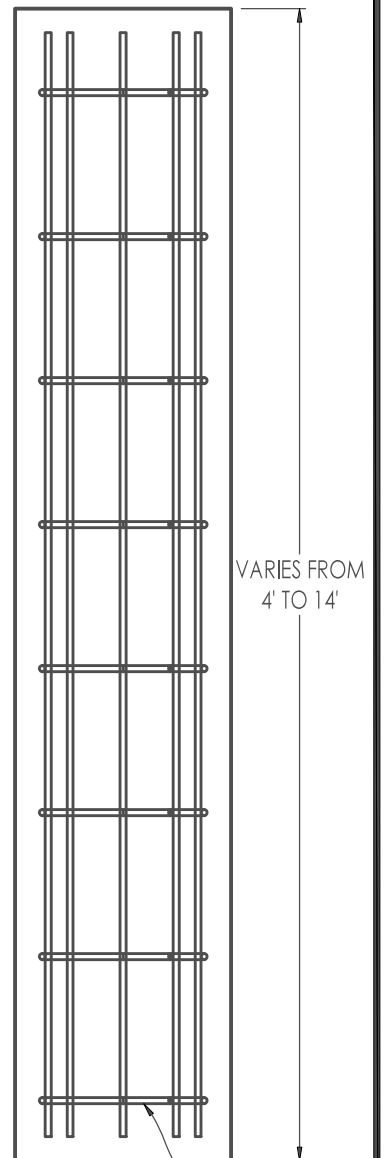

PLAN & ELEVATION

NOTES:

1. CONCRETE: 4,000 PSI @ 28 DAYS MIN.
2. REINFORCEMENT, ASTM A615

APPROXIMATED WEIGHT:  
18" Ø : 0.14 TON./V.F.



**LIGHT POLE FOUNDATION**

18" Ø LIGHT POLE BASE

**1.0**